

QUICKFRAMES

The Leader In Engineered Structural Support Systems

Drop-in Frame (Weldable)



WHEN TO USE

- **Non-mechanical rooftop equipment** (i.e. items unlikely to move)
- **New construction only** - must be welded-in before the deck is laid
- Delivered **pre-assembled** - just "drop-in", weld and go
- Detailing of individual frames is complete

BENEFITS

- **Custom-sized** to your specifications and drawings
- Single-rail system offers **lower-overall cost**
- **Adjustable** intermediate rail locations (if necessary)
- **No on-site assembly** required
- 16Ga 50ksi rails support 2' to 8' joist spacings and 15" to 6' opening sizes
- 12Ga 50ksi rails support up to 10' joist spacings and up to 8' opening sizes



APPLICATIONS

- Commercial/industrial/retail buildings: steel joists or I-beams and steel decking (e.g. B-deck)
- Supports rooftop equipment including:
Skylights, roof drains, roof hatches, etc.

INSTALLATION

- Certified welder required
- Decking must not be installed (if so, use QuickFrames adjustable frames)
- Can be craned into place or lifted in a man-lift or hoist

DROP-IN FRAME LOAD CAPACITIES

EXAMPLE 16Ga STATIC FRAME LOAD CAPACITIES (LBS) *						
Joist/Beam/Truss	Opening/Curb Size (running parallel to joist/beam/truss)					
Spacing	3'	4'	5'	6'	7'	8'
4'	1858	1788	1718	1648	1578	1508
5'	1813	1728	1643	1558	1473	1388
6'	1788	1688	1588	1488	1388	1288
8'	1678	1548	1418	1288	1158	1028

* Maximum loads shown are for the QuickFrames DIY frame only. Dead / Live Load maximum: 20PSF / 20PSF Snow Load (maximum): 20PSF Wind Load (maximum): 115 mph Seismic: B Conforms to: ASCE / SEI 7-05/7-10/7-16 and ANSI 2007-2016 NA



Need frames yesterday?
We've got you covered!

QUICKFRAMES

710 W Broadway Rd Ste 503, Mesa, AZ 85210
www.quickframes.com sales@quickframes.com
(480) 464-1500

QUICKFRAMES

The Leader In Engineered Structural Support Systems

Drop-in Frame (Weldable)



Components

Rails: 16Ga 50KSI, G-90 galvanized steel, cold formed in a channel configuration with 5 $\frac{3}{4}$ " depth, 1 $\frac{3}{4}$ " top flanges, and 1 $\frac{3}{4}$ " bottom flanges.

Joist Hangers: Cold formed 3/16" (black) HR steel plate.

Angle Brackets: 10Ga, 50KSI, G-90 galvanized, cold formed.

Hardware:

- 1" x 1/2" SAE Grade 5 Zinc Carriage Bolt
- 3/4" x #13 serrated zinc coated flange nut.

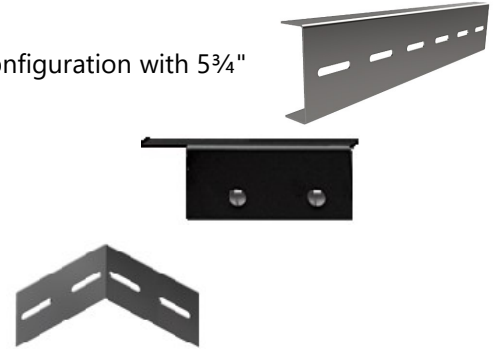

ORDERING DETAILS

DETAILED SHOP DRAWINGS REQUIRED

QuickFrames drop-in frames are manufactured to your specific size requirements. Each drop-in frame requires a unique shop drawing and reference number.

Example shop drawing:

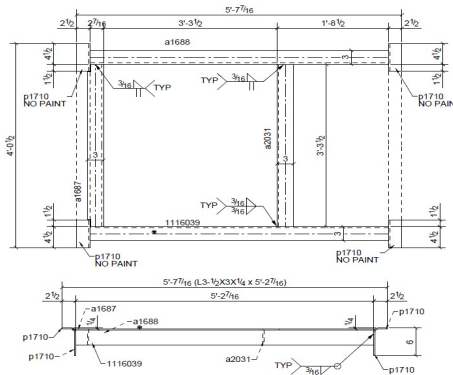

SHIPPING

QuickFrames ship on pallets and a forklift is required to unload from the freight carrier. Liftgate service is available for an additional shipping charge.



PATENT #
6,729,083

OTHER QUICKFRAMES SYSTEMS

- **QuickFrames Adjustable Frames:** Fully adjustable, bolt-in, pre-engineered frames for all project types.
- **QuickFrames DIY Frames:** Cut-to-length, bolt-in frames for small or last minute remodeling/TI projects.

To learn about all the advantages QuickFrames has over conventional roof frames – including some major safety and cost advantages – call 480.464.1500 or visit www.quickframes.com.



Need frames yesterday?
We've got you covered!

QUICKFRAMES

710 W Broadway Rd Ste 503, Mesa, AZ 85210
www.quickframes.com sales@quickframes.com
(480) 464-1500